

## NEW SOCCER COMPLEX TO DRASTICALLY ALTER GOLDEN GATE PARK AND OCEAN BEACH

The Recreation and Park Department is planning to build a soccer complex in the western end of Golden Gate Park behind the Beach Chalet, replacing the current grassy practice meadow with larger artificial turf fields and adding intensive 60 ft. tall sportsfield lighting. Eventually, two more fields will be added, enlarging the complex to an area one-half the width of Golden Gate Park and larger than Candlestick Stadium. This project will change the western edge of the Park from parkland to a highly developed urbanized space. Yet, *very little outreach has gone out to San Franciscans about this change to the character of Golden Gate Park and Ocean Beach.*



The current practice soccer fields are in a grassy meadow surrounded by groves of trees.



Project with night lighting - computer simulation presented at public meetings by the City Fields Foundation

The proposed soccer complex will take up more land and includes a championship field. Night lighting will be on from sunset until 10:00 p.m. all year. The field will be artificial turf. According to RPD planning documents, this project will eventually contain six fields, not the four fields shown in the simulation.



South Sunset Playing Field - sportsfield lighting seen from four blocks away. What will be the experience at Ocean Beach, with this type of lighting nearby?



The current soccer fields are tucked behind these groves of trees. Over 60 trees and tall shrubs will be removed for this project. The remaining trees vary in height, from 20 to 40 feet. The new 60 foot stadium lights will be clearly visible, day or night.

*We are in favor of active youth recreation! But young people also deserve to know what natural parkland is like and to enjoy the night skies at Ocean Beach without the intrusion of intensive night lighting and the degradation of wildlife habitat. **THIS IS THE WRONG PLACE FOR THIS PROJECT!***

**ACTION ALERT! THE PLANNING DEPARTMENT IS CONSIDERING THE NEED FOR AN EIR - TO LET THEM KNOW THAT THIS PROJECT NEEDS A FULL ENVIRONMENTAL IMPACT REPORT! CONTACT US AT : [www.sfoceanedge.org](http://www.sfoceanedge.org) [sfoceanedge@earthlink.net](mailto:sfoceanedge@earthlink.net)**

## GOLDEN GATE PARK AND OCEAN BEACH THREATENED BY SPORTS COMPLEX

There are plans to change the western end of Golden Gate Park from a grassy meadow to artificial turf, concrete paths, asphalt, 20 foot high fences, and stadium lighting:

- Up to five large artificial turf fields = gravel, crushed tires and a plastic carpet of fake grass
- Stadium lights mounted on 60 foot high poles that will be visible from Ocean Beach
- Bright sports lights turned on from before sunset until 10 p.m., 365 days a year
- Destruction of the grassy meadow, removal of over 60 large trees and tall shrubs
- More pavement in the Park for sidewalks and parking
- More lighting for the sidewalks and parking
- More traffic through the neighborhoods and the Park – this location is far from mass transit and does not support SF's position as a transit first city .
- The loss of a landscape area over half the width of Golden Gate Park, an area larger than Candlestick Park Stadium!

This project goes counter to the 1998 Golden Gate Park Master Plan, a document that was formulated over 10 years by a wide range of citizens and organizations.

*This is a BIG project. Golden Gate Park belongs to all San Franciscans. We have a right to be fully informed about this project.*

[sfoceanedge@earthlink.net](mailto:sfoceanedge@earthlink.net) [WWW.SFOCEANEDGE.ORG](http://WWW.SFOCEANEDGE.ORG)

### **THIS PROJECT IS ON A FAST TRACK FOR APPROVAL. Please:**

- ✓ **Write the Planning Department today - ask for a full Environmental Impact Report:**

Mr. Don Lewis  
Major Environmental Analysis  
SF Planning Department  
1650 Mission Street, Suite 400  
San Francisco, CA 94103  
[don.lewis@sfgov.org](mailto:don.lewis@sfgov.org)

- ✓ **Copy us on all your letters**
- ✓ **Write the Supervisors, the Mayor, and the Recreation and Park Commission - ask for a full EIR**
- ✓ **Tell your friends and neighbors**
- ✓ **Contact us and get put on our Alerts! List**
- ✓ **Sign our petition!**

See our website for more information on this project and for notices about upcoming meetings.

[WWW.SFOCEANEDGE.ORG](http://WWW.SFOCEANEDGE.ORG)

Email us at:  
[sfoceanedge@earthlink.net](mailto:sfoceanedge@earthlink.net)

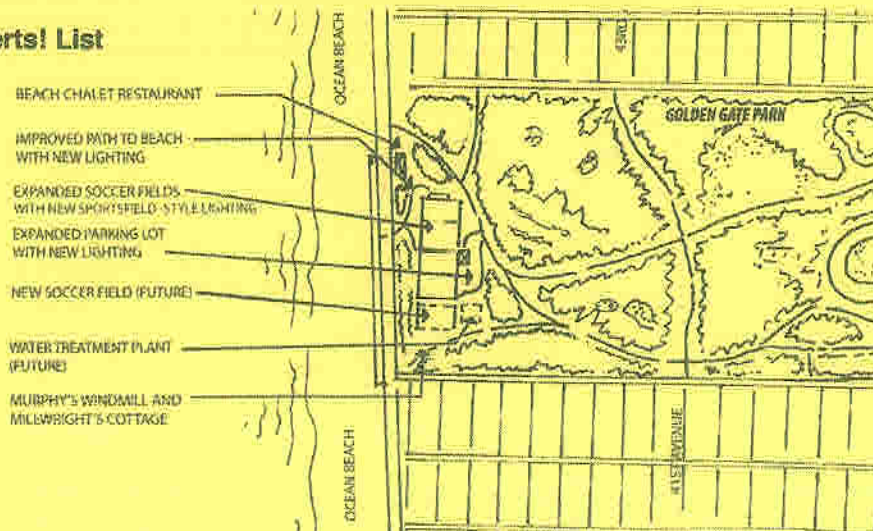



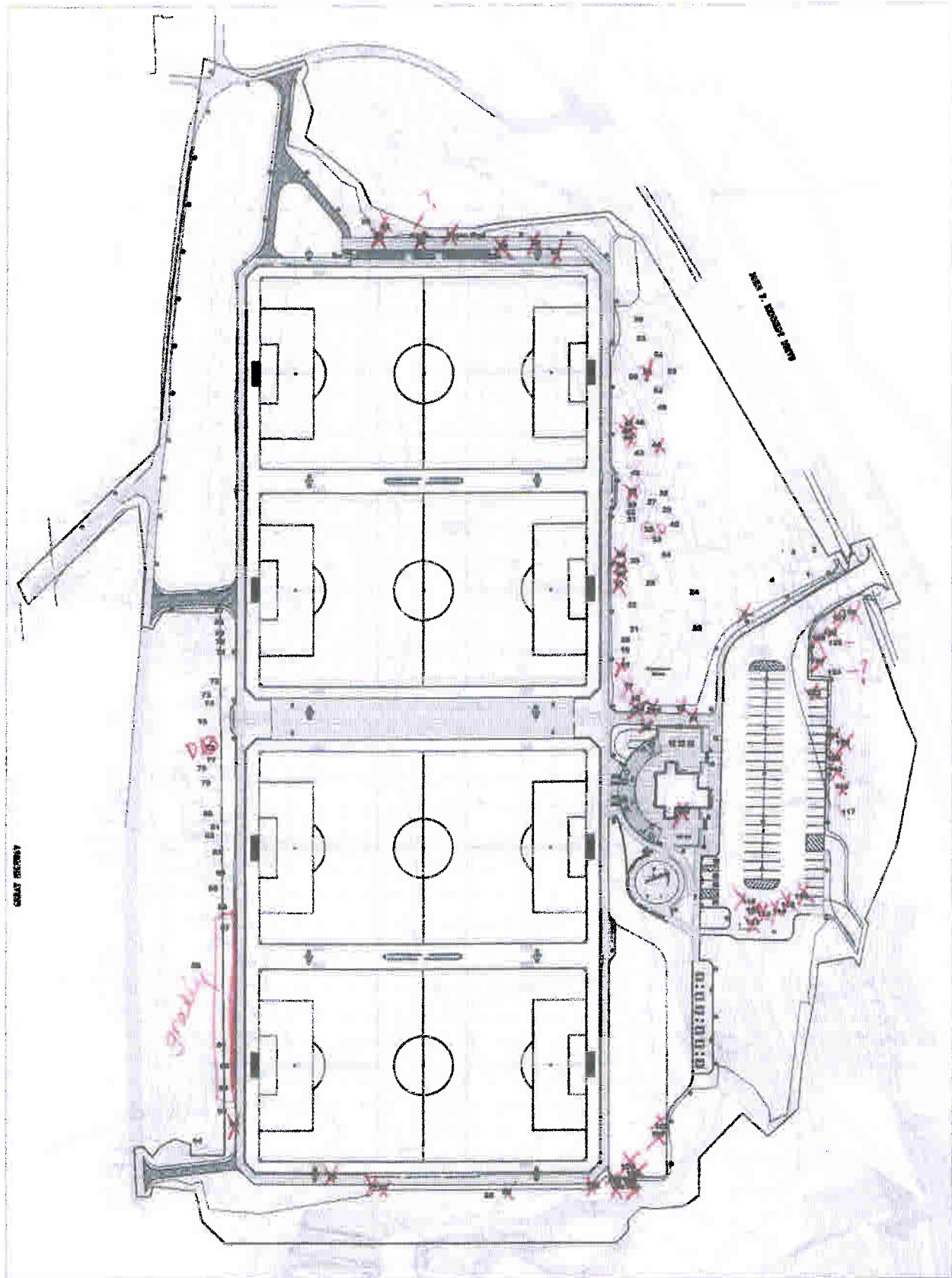

September 2009  
No Scale

Note: Base map provided by City Fields Foundation, San Francisco, CA  
Numbers and numbered tree locations are approximate.



2130 Mission Drive | Suite A1 | Pleasanton, CA 94566  
Phone 925-494-0211 | Fax 925-494-0255

## Trees and Large Shrub Survey

Golden Gate Park Soccer Fields  
San Francisco, CA

Prepared for:  
City Fields Foundation  
San Francisco, CA

**GOLDEN GATE PARK AND OCEAN BEACH THREATENED BY SPORTS COMPLEX**

We are concerned about the proposal to change the western end of Golden Gate Park from a grassy meadow to artificial turf, concrete paths, asphalt, 20 foot high fences, and stadium lighting with:

- Up to five large artificial turf fields = 7.5 acres of gravel, crushed tires and a plastic carpet of fake grass
- Stadium lights mounted on 60 foot high poles that will be visible from Ocean Beach
- Bright sports lights turned on from before sunset until 10 p.m., up to 365 days a year
- Destruction of the grassy meadow, removal of at least 65 trees and tall shrubs
- More pavement in the Park for sidewalks and parking
- A Championship field far from mass transit centers, bringing more cars into the Park
- The loss of a landscape area over half the width of Golden Gate Park, an area larger than Candlestick Stadium!

We request an Environmental Impact Report for this project and a delay of at least six months, to inform all San Franciscans.

<u>PRINT NAME</u>	<u>SIGN NAME</u>	<u>ZIP CODE</u>	<u>E-MAIL OR OTHER CONTACT INFORMATION FOR VERIFICATION</u>

---

**Please mail this petition to:** SF Ocean Edge, 1243 42<sup>nd</sup> Avenue, San Francisco, CA 94122 **or** contact us for pick-up: [sfoceanedge@earthlink.net](mailto:sfoceanedge@earthlink.net).

For more information, see: [www.sfoceanedge.org](http://www.sfoceanedge.org)